



# *Building Hope*

A New Regional Cancer Center

# Health Healing Hope



Do not be afraid; do not be discouraged.  
Be strong and courageous. This is what  
the Lord will do to all the enemies you  
are going to fight.

*Joshua 10:25*

**(on cover)**

"As a two time cancer survivor, I believe the St. Anthony Cancer Center will show our community that a cancer diagnosis isn't the end of the world. My diagnosis was an opportunity to thrive and live the life I was meant to live. I have already made changes in my personal life and am excited for the future. Every day I wake up with a thankful heart."

**Ann Slechta**

*Mother, Wife, Entrepreneur  
Cancer Survivor*

2 St. Anthony Regional Hospital



# DEAR FRIENDS,

When I contemplate what makes our community great, one of the real standouts to me is our ability to come together. Whether in recognition of new birth or love, a life well-lived or a great victory, our greatest moments are made even better by celebrating with those we love. Together we are more than the sum of our parts.

Thanks to your tremendous support, St. Anthony Regional Hospital & Nursing Home and St. Anthony Foundation have been incredibly blessed. Providing care for our community is a privilege we do not take lightly and the trust you place in our team is humbling. As we come together this summer to celebrate our hospital, we also look to the future and how we can best meet the needs of our region, close to home.

Our new regional cancer center will undoubtedly change lives and build hope for those battling cancer. This is a battle many of us feel personally as patients, families and a community. This is a fight we are willing to take on as a community so those we love know they are never alone.

By bringing together the various medical disciplines needed to effectively diagnose and treat cancer, we are providing our west central Iowa community with world-class care within a short drive. This new facility will provide the people, equipment and healing environment our patients and families deserve.

This is the right time for our community to be strong and courageous as we fight alongside our family, friends and neighbors. I look forward to you joining me in supporting the our new regional cancer center.

Sincerely,



**Edward H. Smith, Jr.**  
President & CEO



# THE FOUNDATION

Established in 1992, the role of the St. Anthony Foundation is to improve the health of our community by supporting the continued growth and stability of St. Anthony Regional Hospital. More than \$35 million has been invested by our community in the Foundation to support healthcare ministry including:

- > Expanded outpatient services
- > Enhanced care for Alzheimer's patients and nursing home residents
- > Modernized emergency department facilities and services
- > Developed education facilities on campus
- > Endowed important services that are not reimbursed by insurance or other payers.

In our most recent campaign, our donors generously gave to permanently endow our spiritual care services, an important part of caring for individuals in challenging, tragic or difficult times of life. Through generous support from the community and leadership from the Foundation Board, endowments provide annual support to essential hospital services.

**In 2018, our endowed scholarship funds will support 30 people pursuing an education in healthcare related fields.** More than \$50,000 is provided annually for residents of west central Iowa who represent the future of our ability to meet the healthcare needs of our community.



“Working at St. Anthony Clinic has been such a blessing. I love the patients I’m able to see and the staff that I work with. Being a cancer survivor truly allows me to sympathize with our patients and share the love of Christ, even in times of trial.

**Shelley Diehl, PA-C**

*Mother, Wife, Healthcare Provider  
Cancer Survivor*

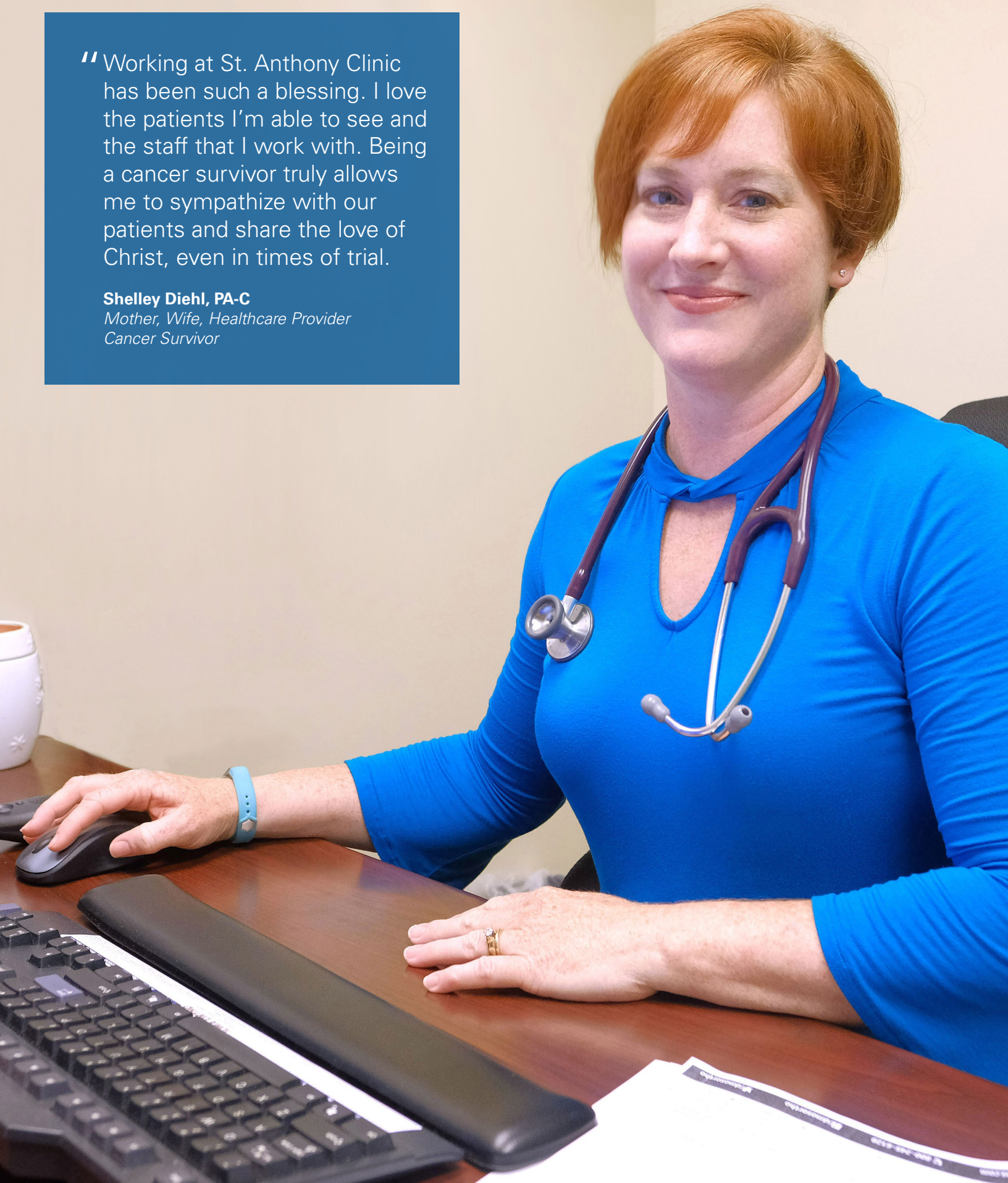



“ St. Anthony staff treated me as more than just a patient; they made me feel like I was part of a family. The staff always had a smile which made it easier to walk in the door for treatment. Seeing their smiles made the whole day much more pleasant and easier to handle. They helped me through one of the hardest times of life, with medicine, and faith as well.

**Rick Ramsey**

*Dad, Husband, Cyclone Fan  
Cancer Survivor*

# WHO WE SERVE

## Geographic Area Map of Western Iowa

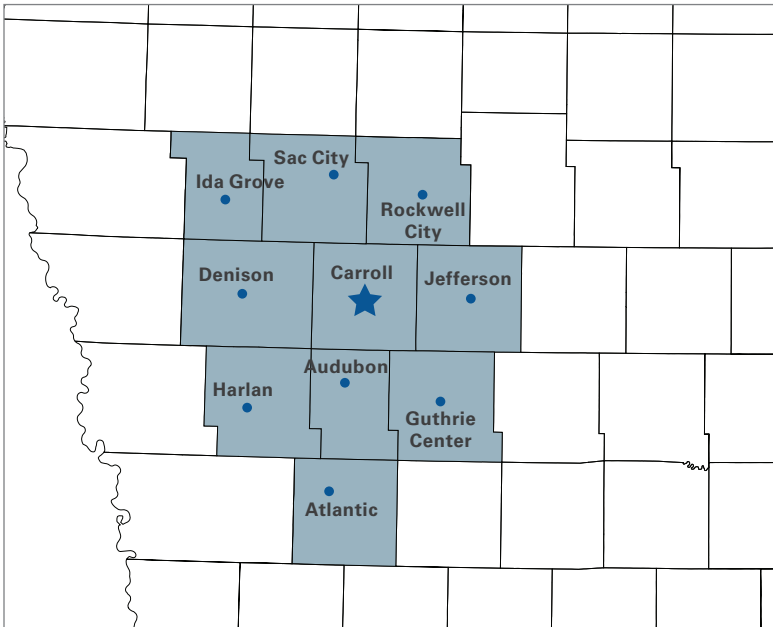

## New Cancer Cases Graph (by County)

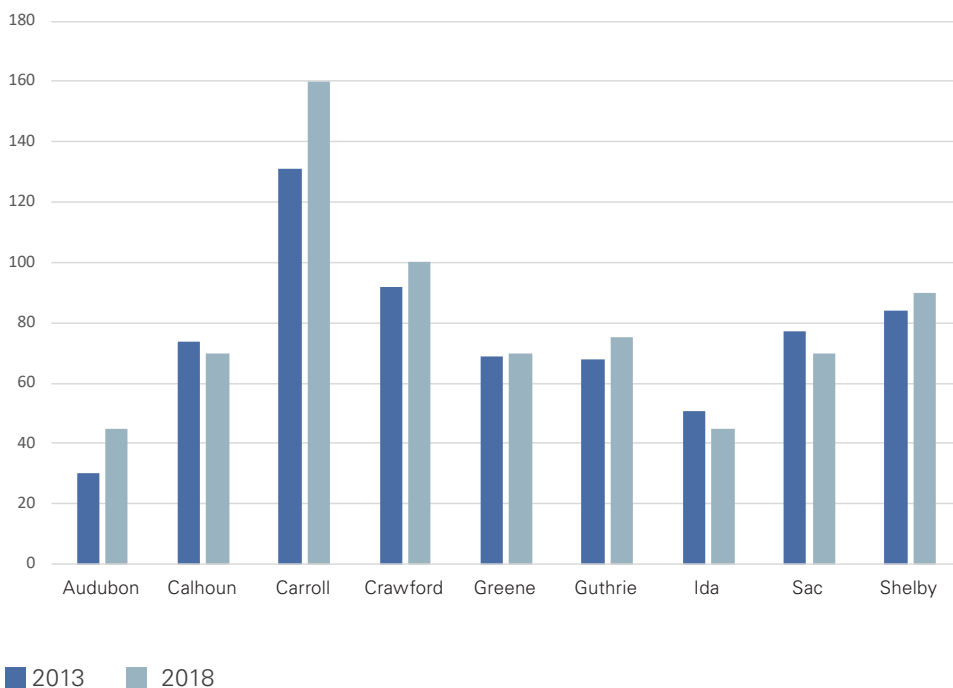

“It helped having good rapport with my doctors and nurses. I felt they were all in the fight with me and they formed a great team that did what was best for me.”



**Betsy Laing**  
Cancer Survivor

\*Information provided by the State Health Registry of Iowa



“St. Anthony has a long tradition of providing a very high level of cancer care to people in the region. The goal is to be able to provide this high quality, compassionate care locally so that patients don’t have to travel long distances several times a week in order to receive treatment.”

**—Dr. Mark Westberg, MD**  
*Hematology & Medical Oncology*



“These improvements are all about the patient and the healing environment they need. We are obligated to do everything we can to afford patients and their families the opportunity to heal close to home.”

**—Dr. Robert Behrens, MD**  
*Hematology & Medical Oncology*

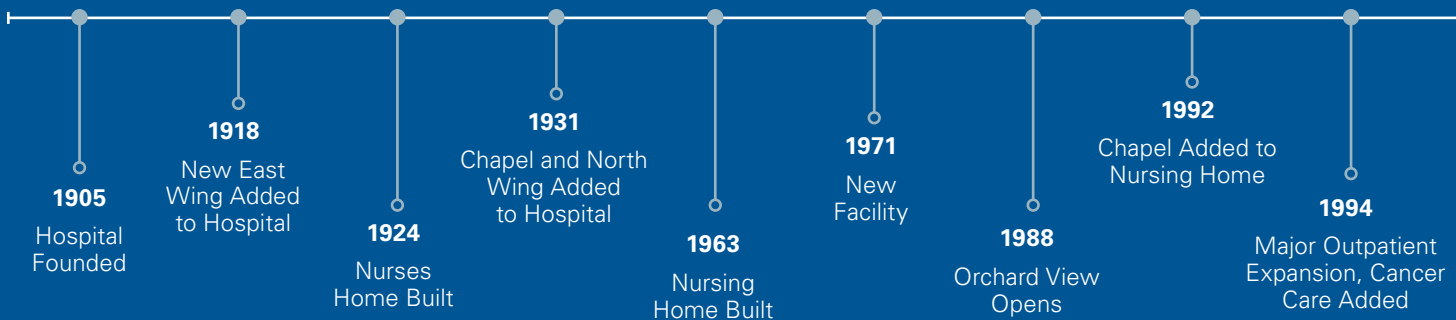





“In the spirit of this tradition, St. Anthony is moving forward on improving this by bringing all of its cancer services into one center. This will not only provide the state of the art equipment, but also bring together the best physicians, nursing and technologists to deliver a team approach to cancer care. This is a very exciting time for cancer care at St. Anthony and I feel very privileged to be a part of it.”

—**Randal Hess, MD**

*St. Anthony Radiation Oncology*

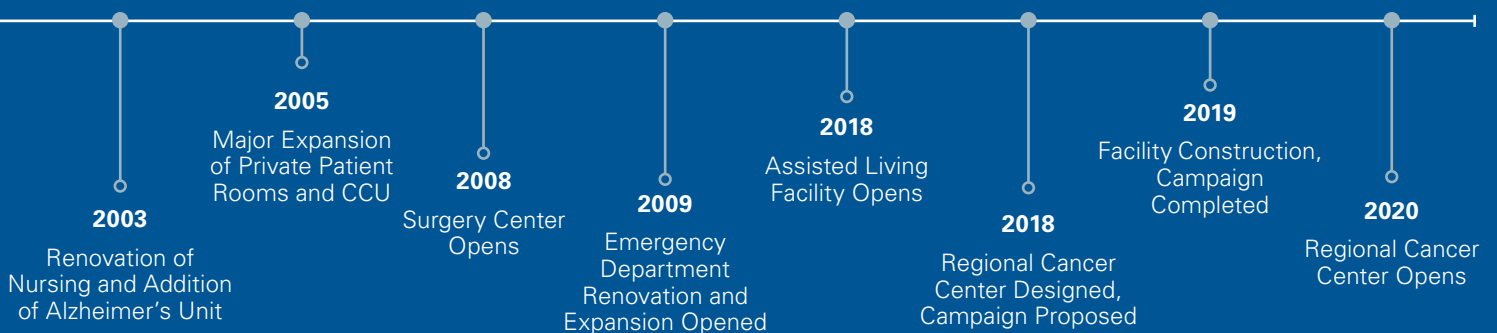



“ I am very grateful for the care and compassion that I received from the oncology staff of St. Anthony. They lightened my battle with their encouragement and kindness. Their continuous support gave me hope and helped me become the person I am today.

**Grace Steffes**

*Daughter, Student, Athlete  
Cancer Survivor*

# SITE PLAN

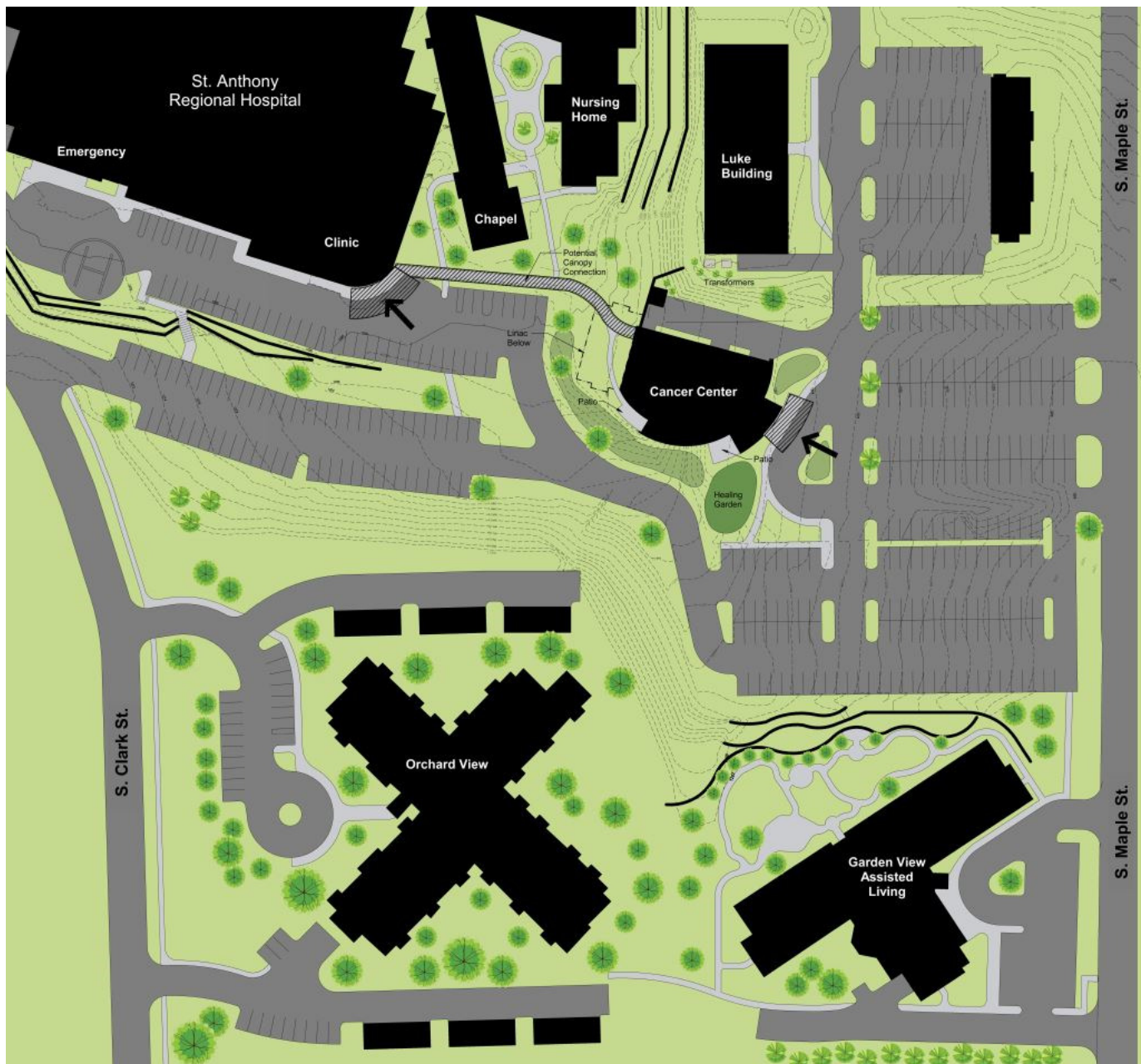

# FLOOR PLANS

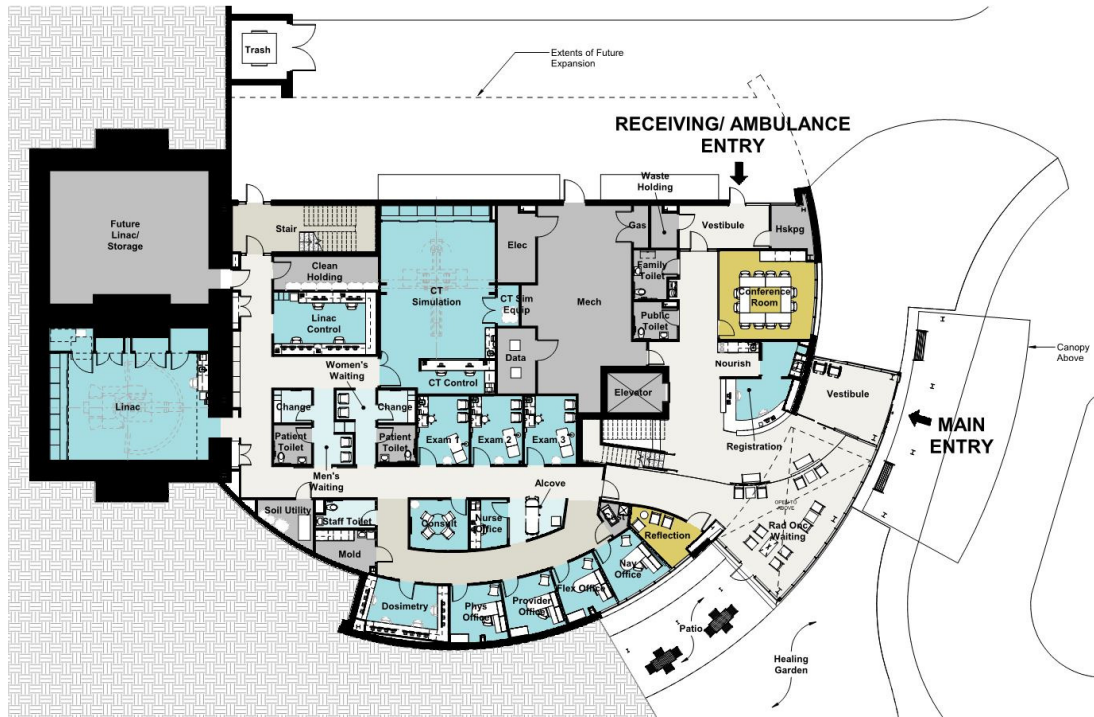

Main Level



Upper Level

# EXTERIOR



Exterior Perspectives

# INTERIOR



Infusion Open Bay



Registration



Waiting Area

## Features of New Cancer Center

- Integration of multi-disciplinary approach
- Improve coordination of care
- Improved patient experience with better waiting areas and lobby
- Private male/female changing rooms and restrooms
- Private treatment rooms (less delay and improved patient privacy)
- Stereotactic Radiotherapy
- Brachytherapy
- Next generation linear accelerator
- Six-axis Gantry Couch offering improved accuracy, better comfort and shorter treatment times
- Upgraded 16-slice CT scanner
- Two linear accelerator vaults (future growth)

“After careful planning and research, St. Anthony has come to the conclusion that now is the time to invest in the future health needs of west central Iowans. I believe acknowledging this need is extremely important because of the disease’s significant impact on our loved ones and I am so grateful that St. Anthony has once again taken the initiative to plan for the future of our communities. Not only will this facility bring the latest technology to our doorstep, it will create an environment where our families, friends and neighbors have the best opportunity to beat cancer.”



**Deb Auen**  
*St. Anthony Foundation  
Board Member*

# COMPARISON

SERVICE/AREA	CURRENT	PROPOSED
Linear Accelerator	Upgrades needed in the next two years	✓ New purchase for the Cancer Center
Consultation Room	✗	✓ Space for family
Reflection Room	✗	✓ An inviting place to collect your thoughts
Blood Draw Room	✗	✓ All in one location
Case Manager/Nurse Navigator	✗	✓ Allowing for better communication
Oncology Certified Nurses	✓	✓ With a combined 145 years of experience
Advanced Tech with Bedside Charting and Bar Scanning	Portable laptops on wheels	✓ More computers for point of care charting
Care Channel and Mass Channel	✓	✓ Bringing the healing power of music to patients
Multi-Function Room	✗	✓ For tumor board, support and group meetings
Chemotherapy	✓	✓ With room to grow for possible clinical trials
Pharmacy	Distant	✓ Close proximity to med/onc unit, enhance interactions, physician availability to pharmacist
Tumor Board	✗	✓ Physicians with different backgrounds meet to discuss patient cases
Privacy	Limited	✓ Private, semi-private, recliner treatment areas
Natural Lighting	✗	✓ Windows that wrap the building
Healing Garden	✗	✓ A place of refuge to promote healing
Parking and Drop off	Limited parking and no drop off	✓ Parking for oncology patients and covered drop-off area
Refreshments	Obtained by Nursing Staff	✓ Self-service refrigerators with ice and healthy snacks
Restrooms	Limited (only two)	✓ Ten restrooms throughout the building
Waiting Areas	Limited	✓ Larger space with a great view



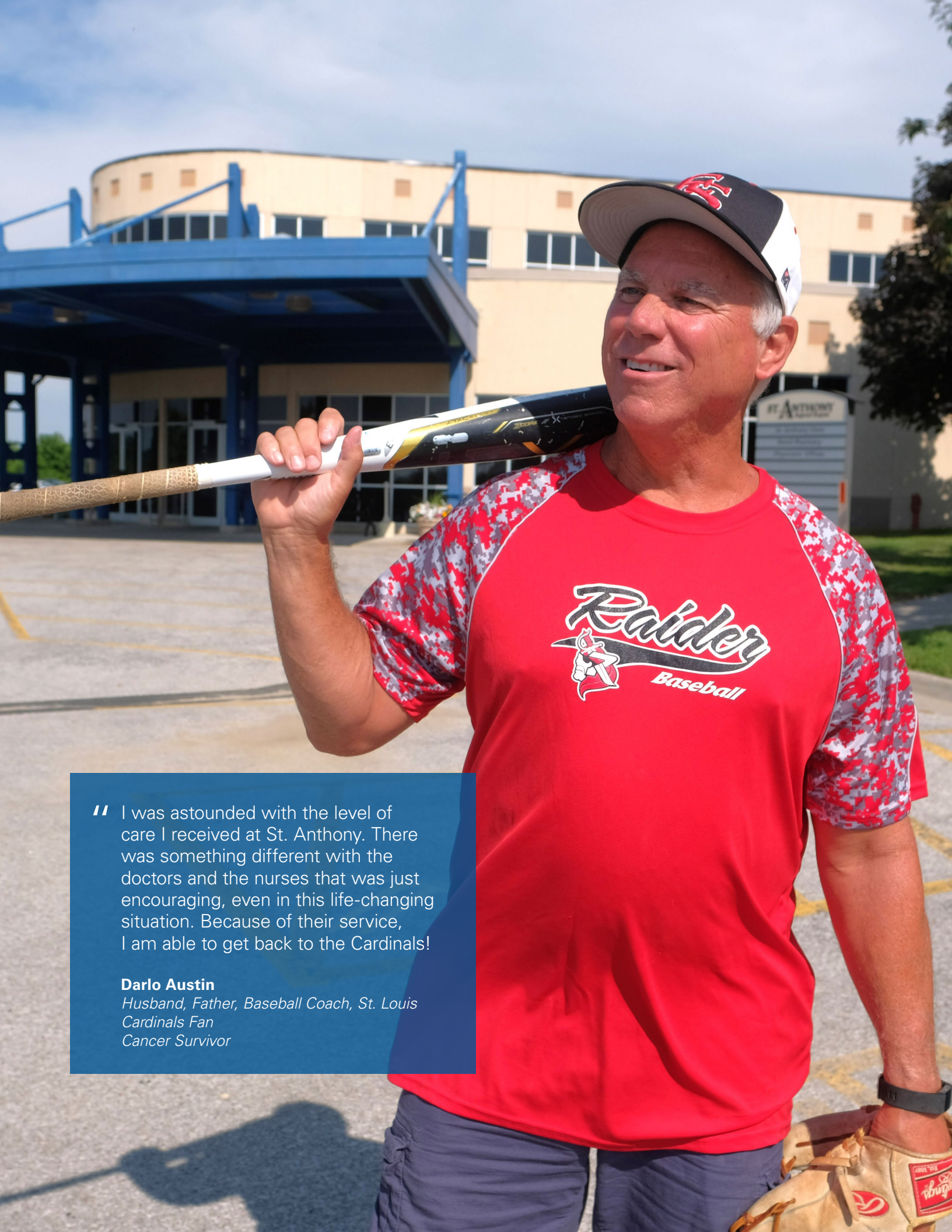

“ I was astounded with the level of care I received at St. Anthony. There was something different with the doctors and the nurses that was just encouraging, even in this life-changing situation. Because of their service, I am able to get back to the Cardinals!

**Darlo Austin**

*Husband, Father, Baseball Coach, St. Louis Cardinals Fan  
Cancer Survivor*

# COSTS

## SARH New Cancer Center Construction Expenses

ITEM	COST
Demolition	\$80,000
Site Development & Parking	\$640,000
Construction	\$5,600,000
Medical Equipment	\$5,600,000
Utilities	\$2,200,000
Design & Engineering	\$1,200,000
Tests, Fees & Permits	\$80,000
Contingency	\$1,100,000
<b>TOTAL</b>	<b>\$16,500,000</b>





Dallas Clark (left), Leah Greteman (center) and Zach Johnson (right)

“ Cancer is the last thing that anyone expects. When I started treatment at St. Anthony, I was quickly put at ease by the warm and generous nurses and staff in the infusion room. I owe a lot to them and to the Lord for helping me through my experience.

**Leah Greteman**

*Daughter, Sister, College Student, Cancer Survivor*

# PROPOSED CAMPAIGN

## Scale of Giving

NUMBER OF GIFTS	GIFT RANGE	GIFT TOTALS
1	\$2,000,000	\$2,000,000
1	\$1,000,000	\$1,000,000
2	\$500,000	\$1,000,000
2	\$250,000	\$500,000
8	\$100,000	\$800,000
8	\$50,000	\$400,000
24	\$25,000	\$600,000
35	\$10,000	\$350,000
70	\$5,000	\$350,000
Many	<\$5,000	\$100,000
<b>TOTAL</b>		<b>\$7,000,000</b>

Gifts typically paid over a three to five year period. Planned or estate gifts present an opportunity to provide for the future of St. Anthony Regional Hospital & Nursing Home. Limited named giving opportunities may be made available for leadership and corporate gifts.



# BOARD MEMBERS

## St. Anthony Hospital Board

- > Tom Gronstal, Chairperson
- > Nick Badding
- > Fred Dolezal
- > Howie Drees
- > Sister Theresa Keller, FSPA
- > Sister Maris Kerwin, FSPA
- > Sister Romana Klaubauf, FSPA
- > Karl Eischeid, DDS
- > Sister Donna Venteicher
- > Peggy White



## St. Anthony Foundation Board

- > Karl Eischeid, DDS, Chairperson
- > Deb Auen
- > Terry Axman
- > Sister Marcia Baumert, FSPA
- > Sister Helen Elsbernd, FSPA
- > Jim Greteman
- > Kim Hackett
- > Kyle Ulveling, MD
- > Ryan Milligan
- > Eric Neu
- > Peggy White



**Ed Smith**, President & CEO

**Trish Roberts**, Development Director



**Trish Roberts, CFRE**

St. Anthony Foundation

311 S Clark Street, Carroll, IA 51401

p. (712) 794 5223 | [www.stanthonyhospital.org](http://www.stanthonyhospital.org)